

**LABEL CODING**

Date 5.17.2023

Drawn MK

Tech Director

File Name Luminary Arts Center

Scale 1/4"=1'-0"

**Production:**  
KFZ

**SET DESIGN:**  
MINA KINUKAWA

**Drawing Title**  
GROUND PLAN  
STANDARD SEATI

**Revision**  
# 5.23.2023

**Drawing #**

1

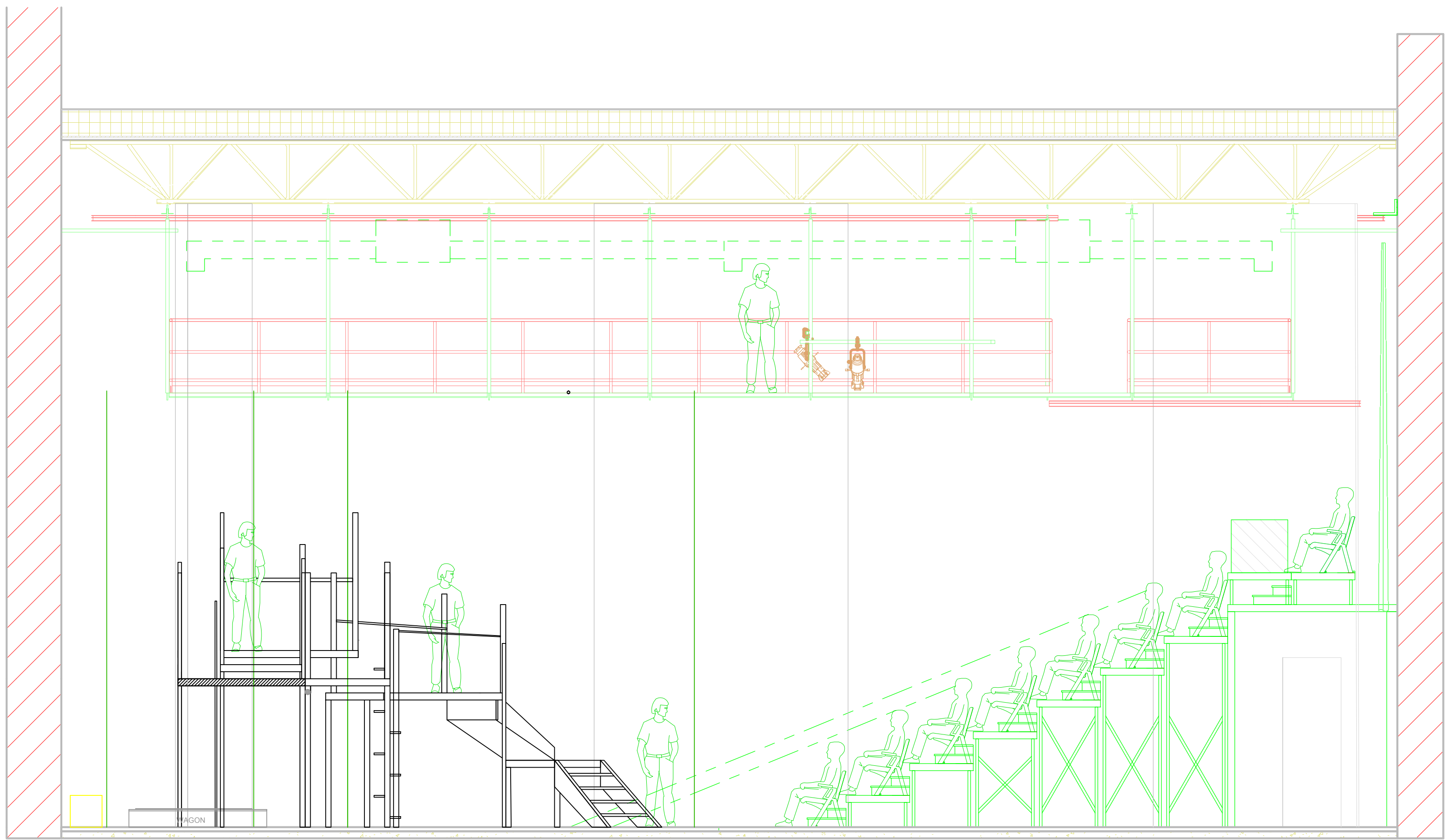

**LABEL CODING**

Date 5.17.2023

Drawn MK

Tech Director

File Name Luminary Arts Center

Scale 1/4"=1'-0"

**Production:**  
KFZ

SET DESIGN:  
MINA KINUKAWA

**Drawing Title**  
SECTION (SL)  
STANDARD SEATING

**Revision**  
# 5.23.2023

**Drawing #**

2

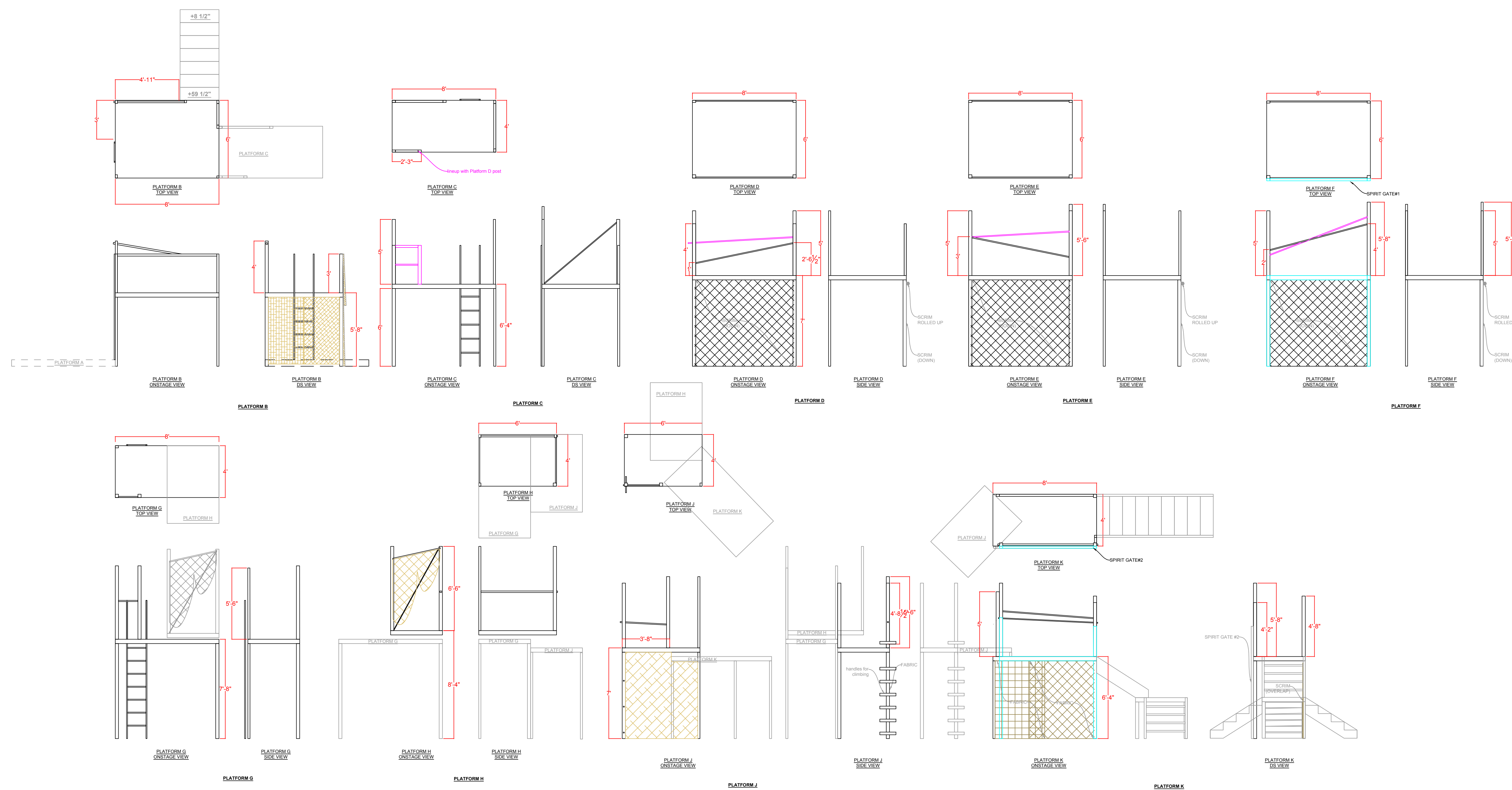

**NOTES:**

- most verticals are 3" width in the directions specified in the drawing. Some vertical "posts" are made with two 2x4s trimmed to actual 3x3 (see drawing)
- Platforms D, E, F use scrim. Other "scrim" and fabric to be negotiated. Placements and amount are TBD based on projection needs as well.
- Note overlapping fabric for actor entrance/exit
- See designer and research for texture and treatment of platforms and fabric
- Both Spirit Gates #1 and #2 hinge to the platforms to swing open. Decorations will be added from the platforms before the scenes. They will return to the "closed" position when not in use.

**LABEL CODING**

Date 5.15.2023

Drawn MK

Tech Director

File Name Luminary Arts Center

Scale 1/4"=1'-0"

Production:  
KFZ

Drawing Title  
PLATFORMS B-K  
STANDARD SEATING

Revision # 6.7.2023

Drawing #

3

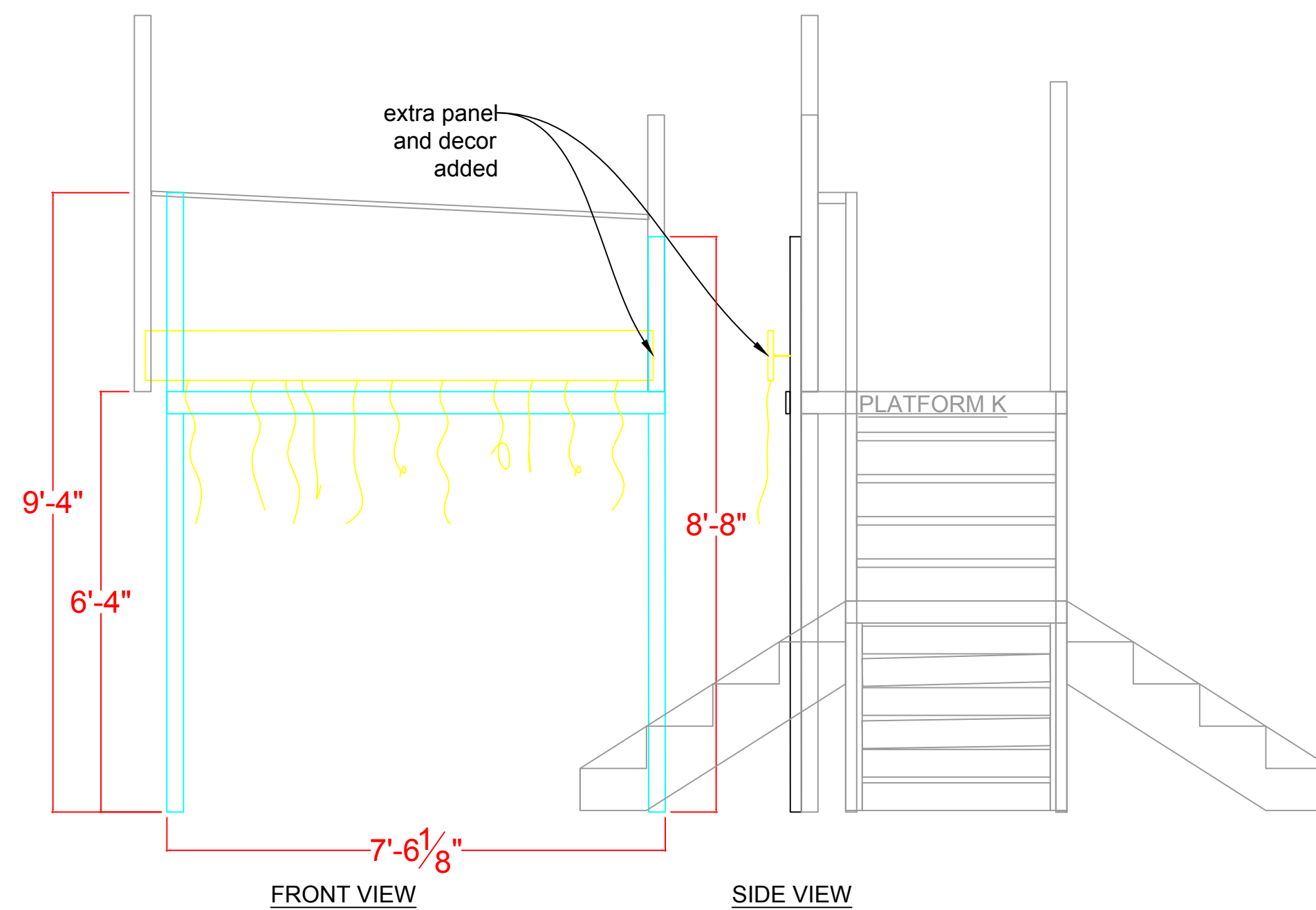
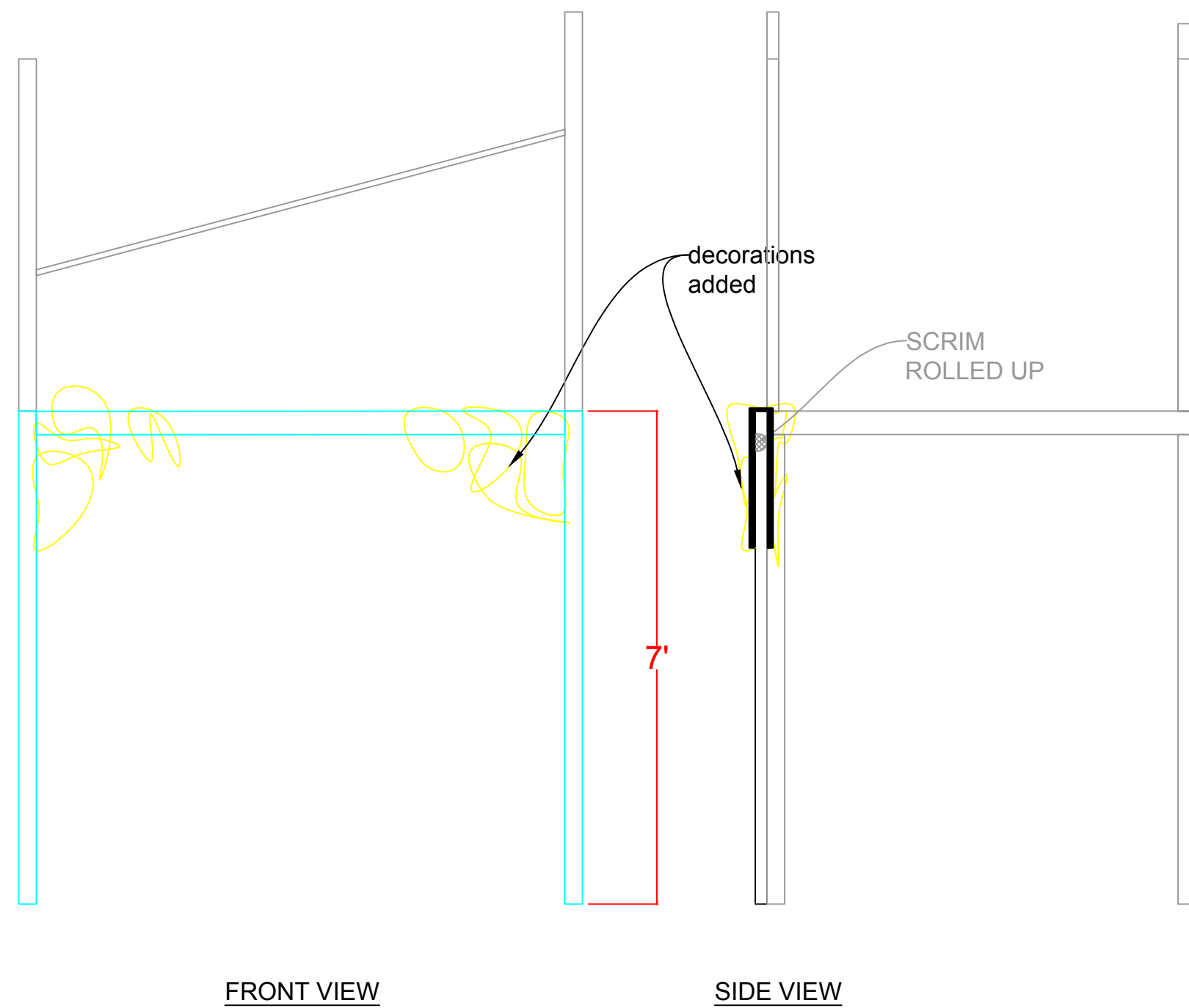
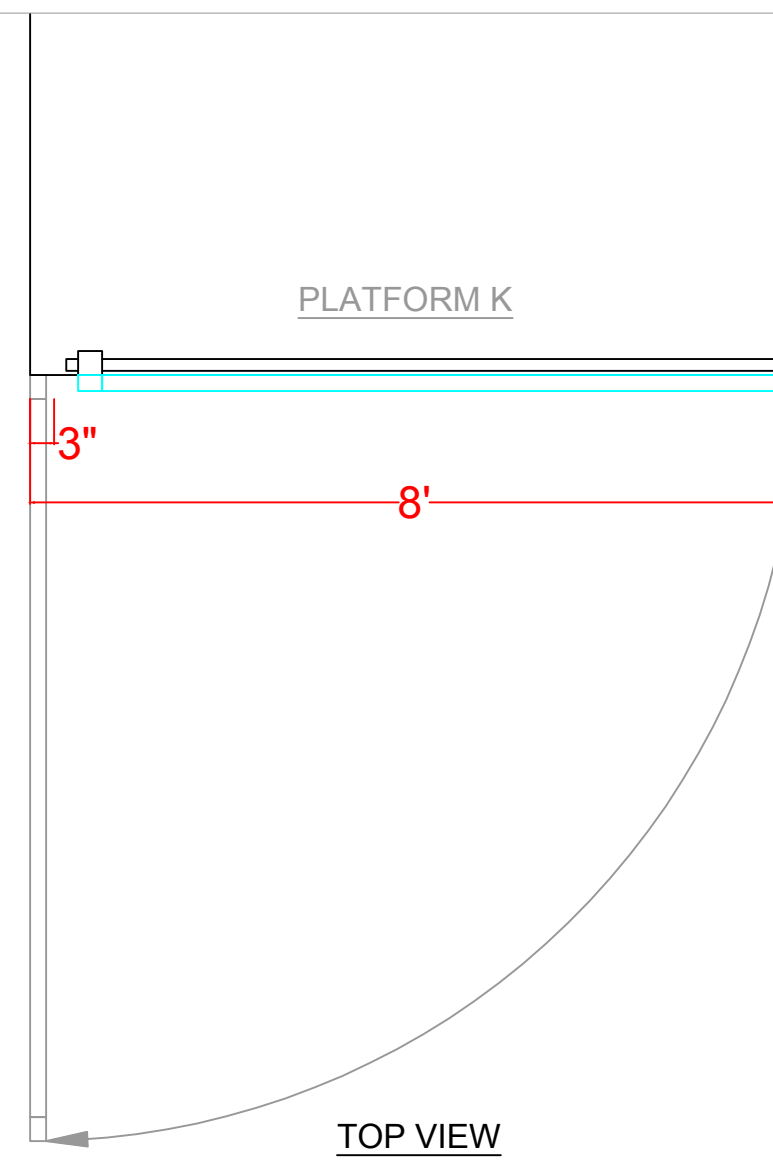
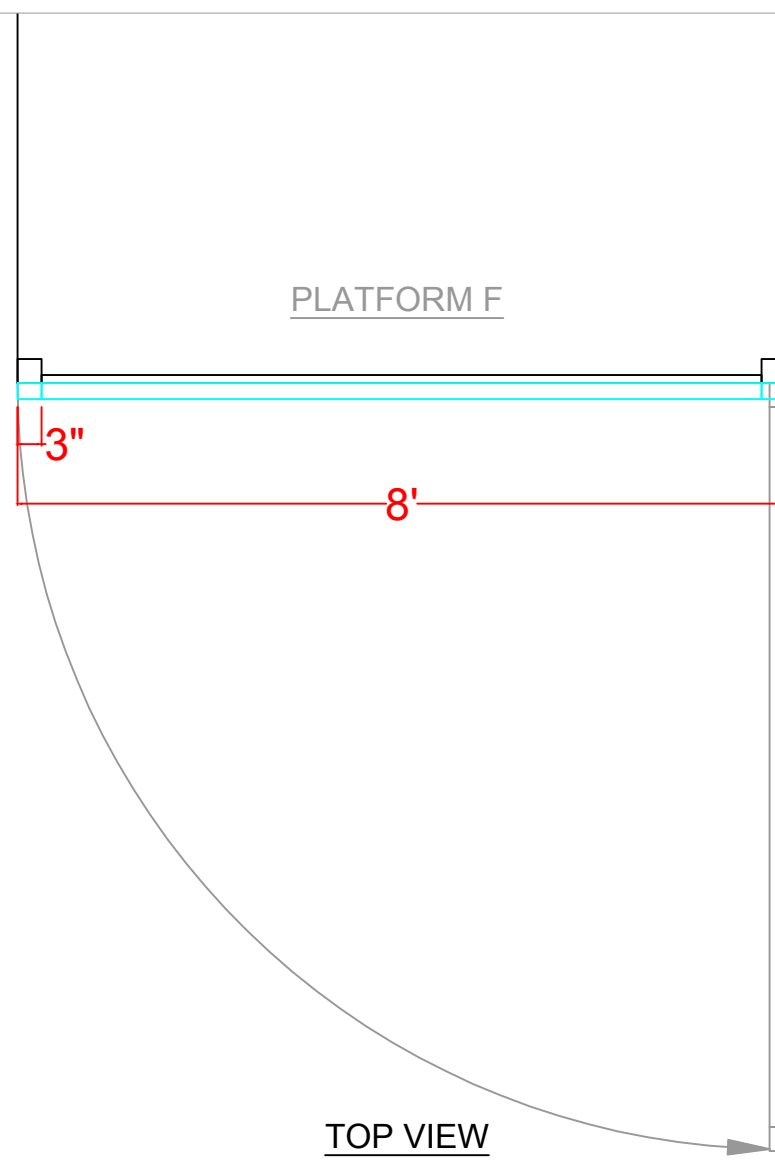
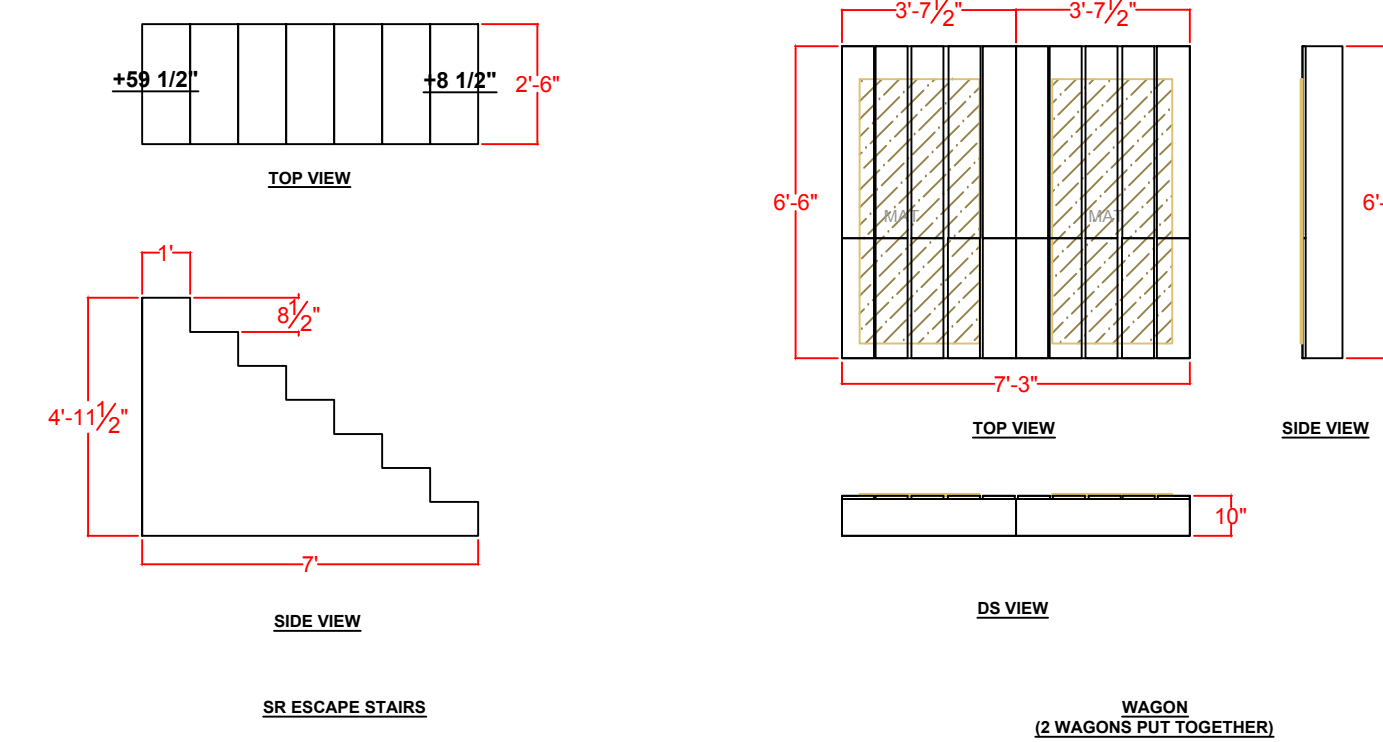
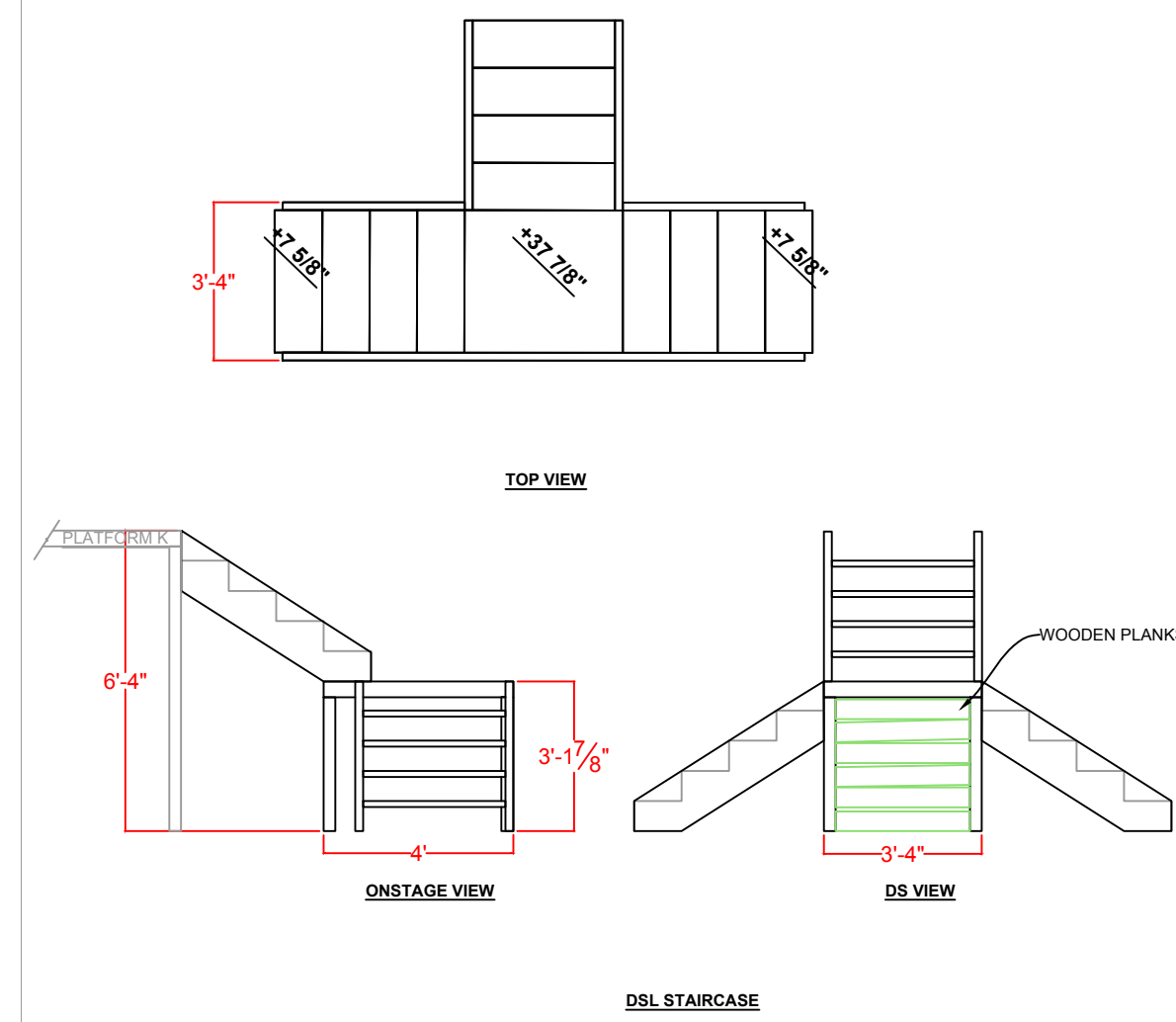
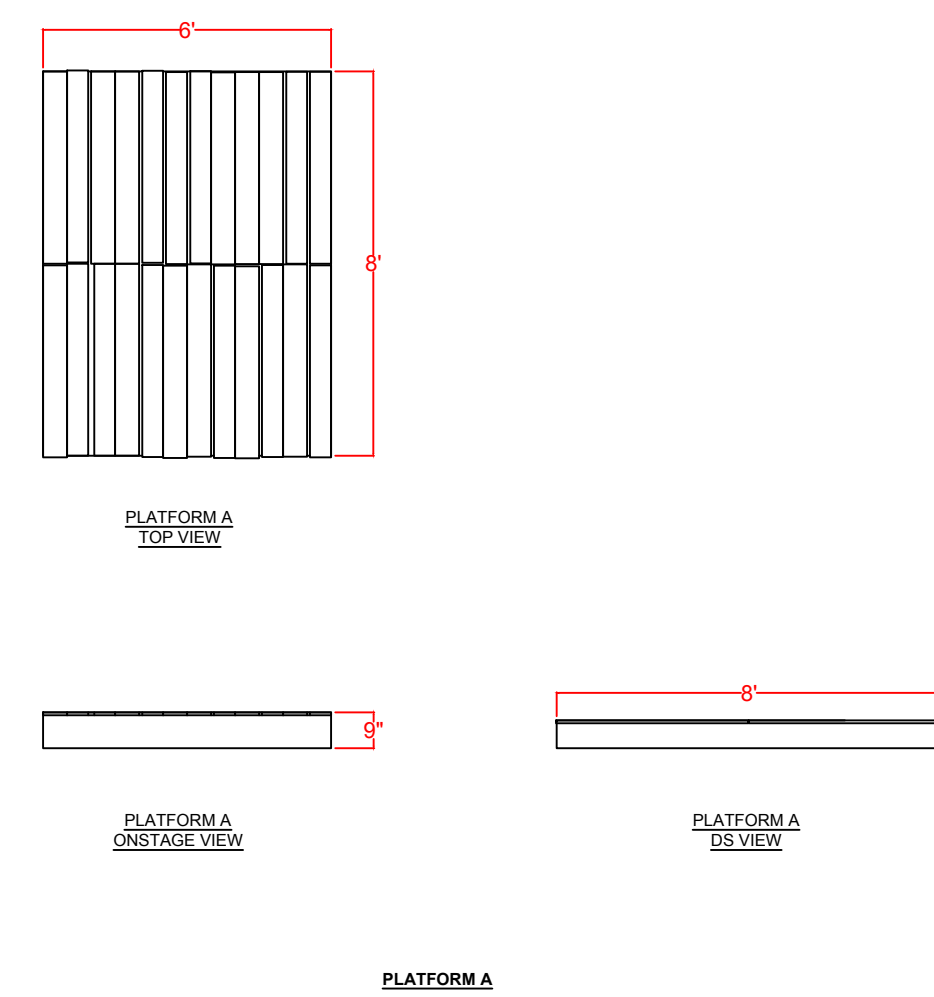

SCALE: 1/2"=1'-0"

**NOTES:**

- Wagons will need to roll in/out freely. Stored under Platform D when not in use. They need to be able to lock together when needed.
- There will be props and furniture placed on the wagons (preset).
- Spirit Gate #1 and #2 hinge to the platforms (Platform F and K). They will swing open to reveal the "Spirit Gate." The decorations will be added before the scenes from the platforms.
- See designer and research for the looks of the Spirit gates.
- Both Spirit Gates #1 and #2 will return to the "closed" position when not in use.
- See Plate#3 for Platform F and K.

**LABEL CODING**

Date	5.15.2023
Drawn	MK
Tech Director	
File Name	Luminary Arts Center
Scale	1/4"=1'-0" (otherwise noted)

**Production:**  
KFZ

**Drawing Title**  
PLATFORM M, A  
SPIRIT GATES  
WAGON, STAIRS

**Revision #**  
5.23.2023

**Drawing #**

4



PLATFORM D  
UPPER LEVEL FABRIC  
IF NEEDED

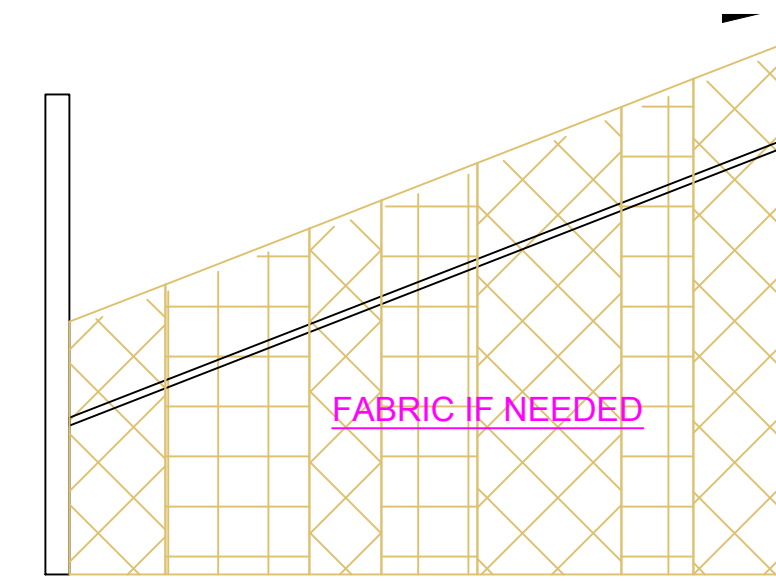

PLATFORM F  
UPPER LEVEL FABRIC  
IF NEEDED

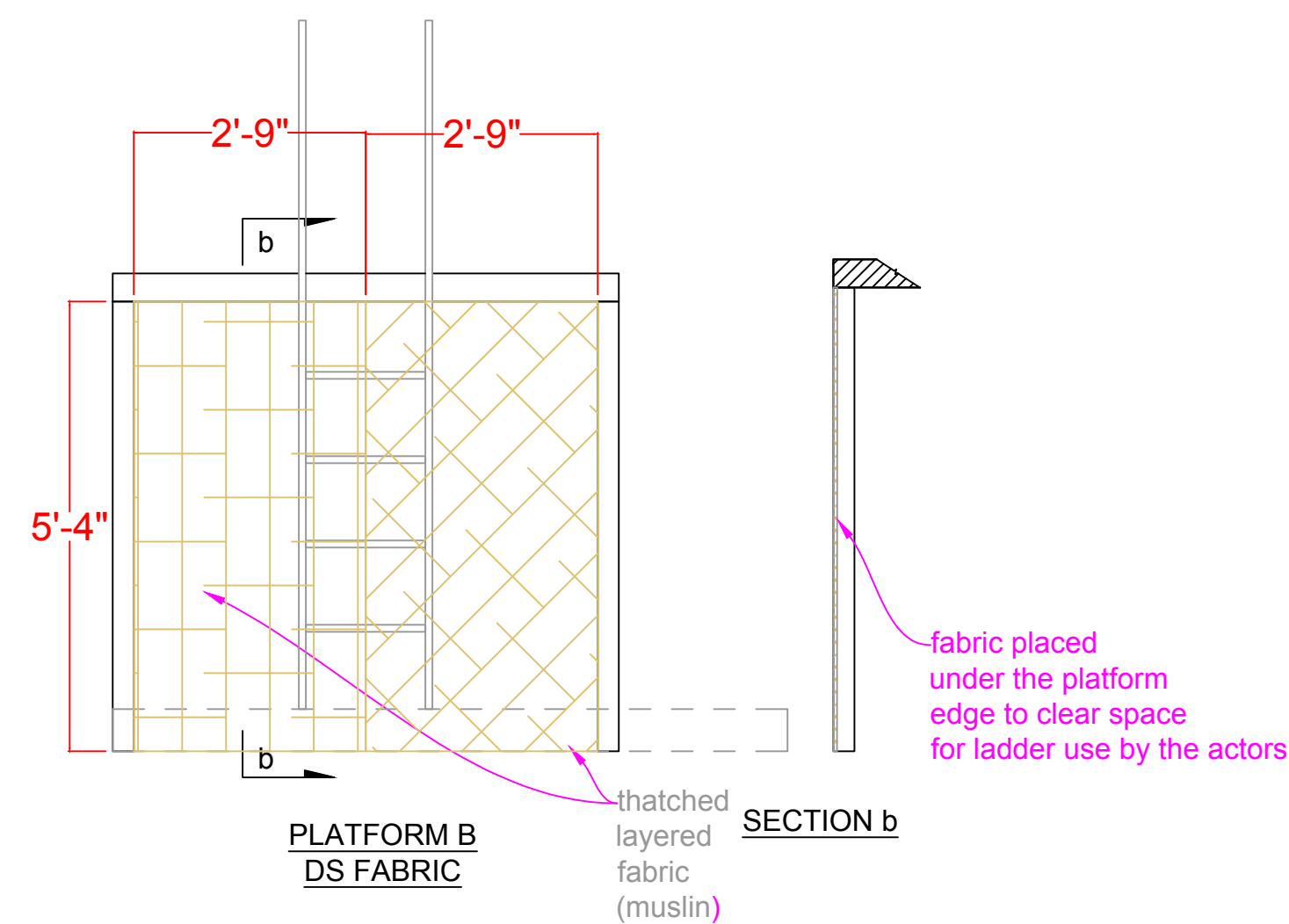

PLATFORM B  
DS FABRIC

thatched layered fabric (muslin)  
fabric placed under the platform edge to clear space for ladder use by the actors

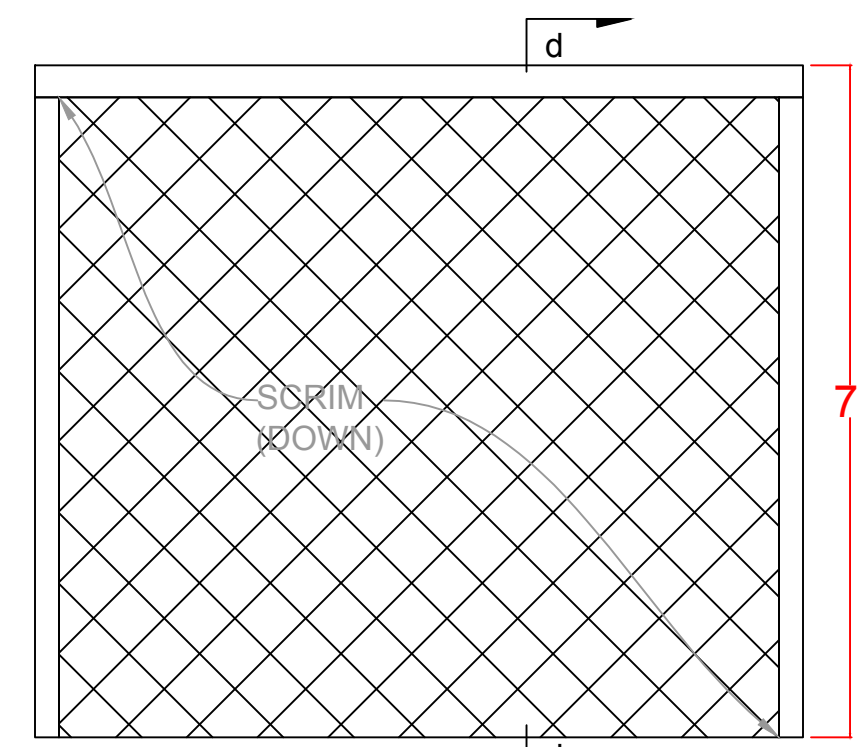

PLATFORM D  
ROLL-UP SCRIM

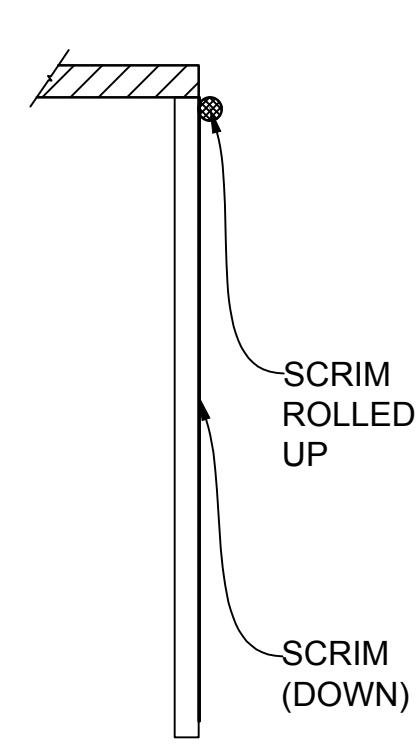

SECTION d

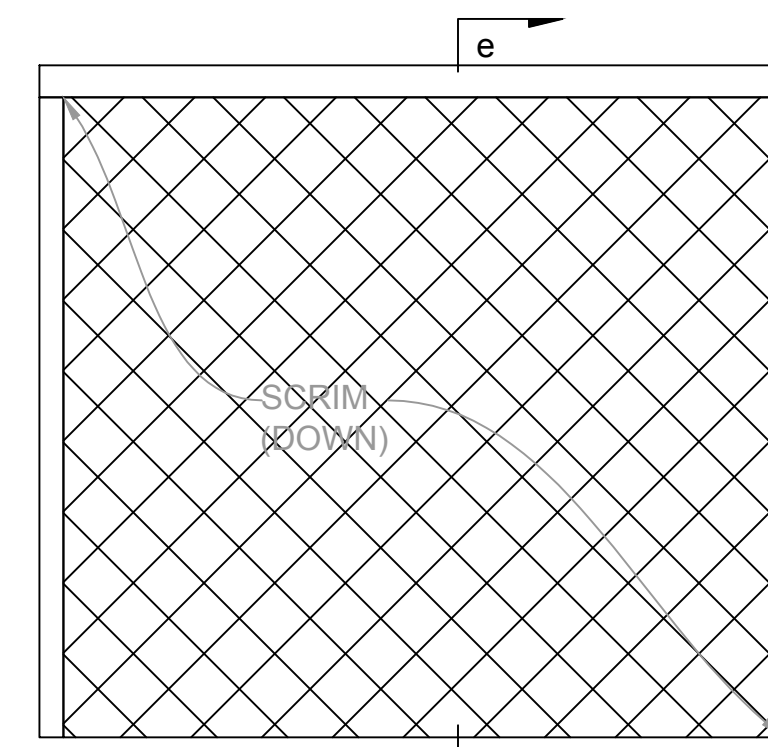

PLATFORM E  
ROLL-UP SCRIM

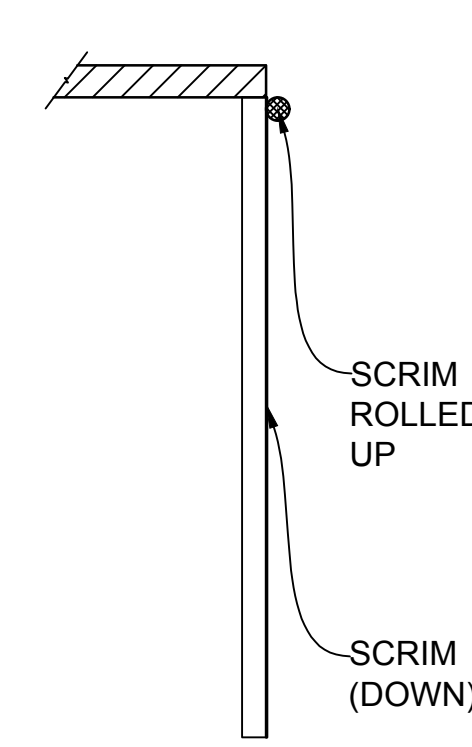

SECTION e

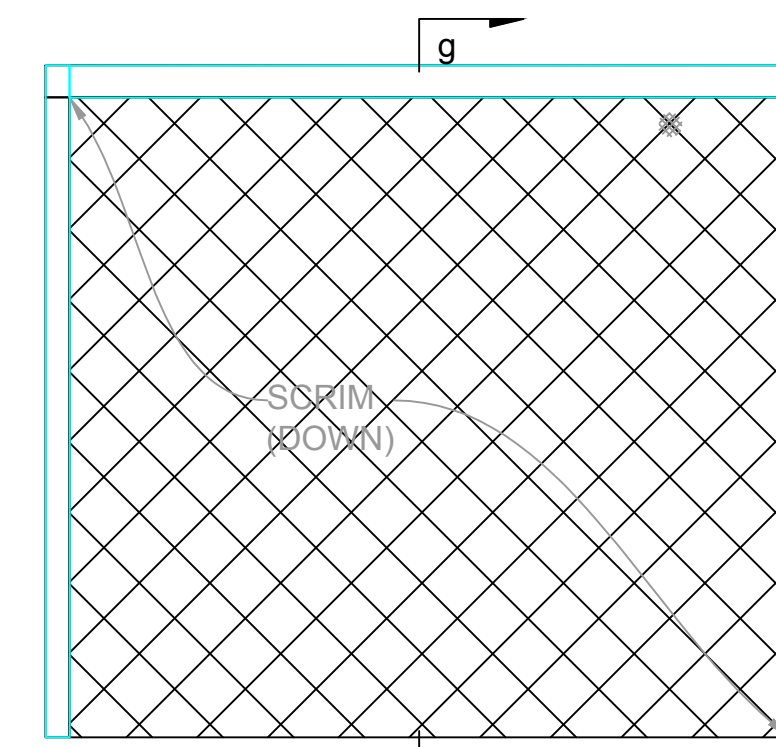

PLATFORM F  
ROLL-UP SCRIM

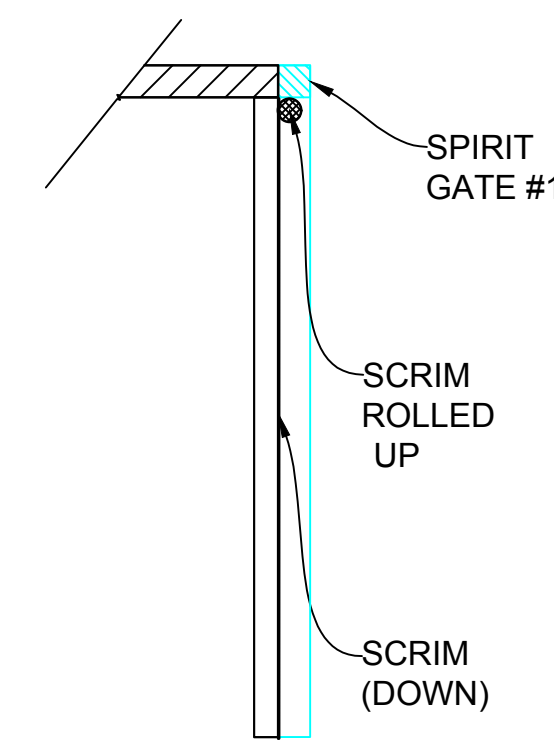

SECTION g

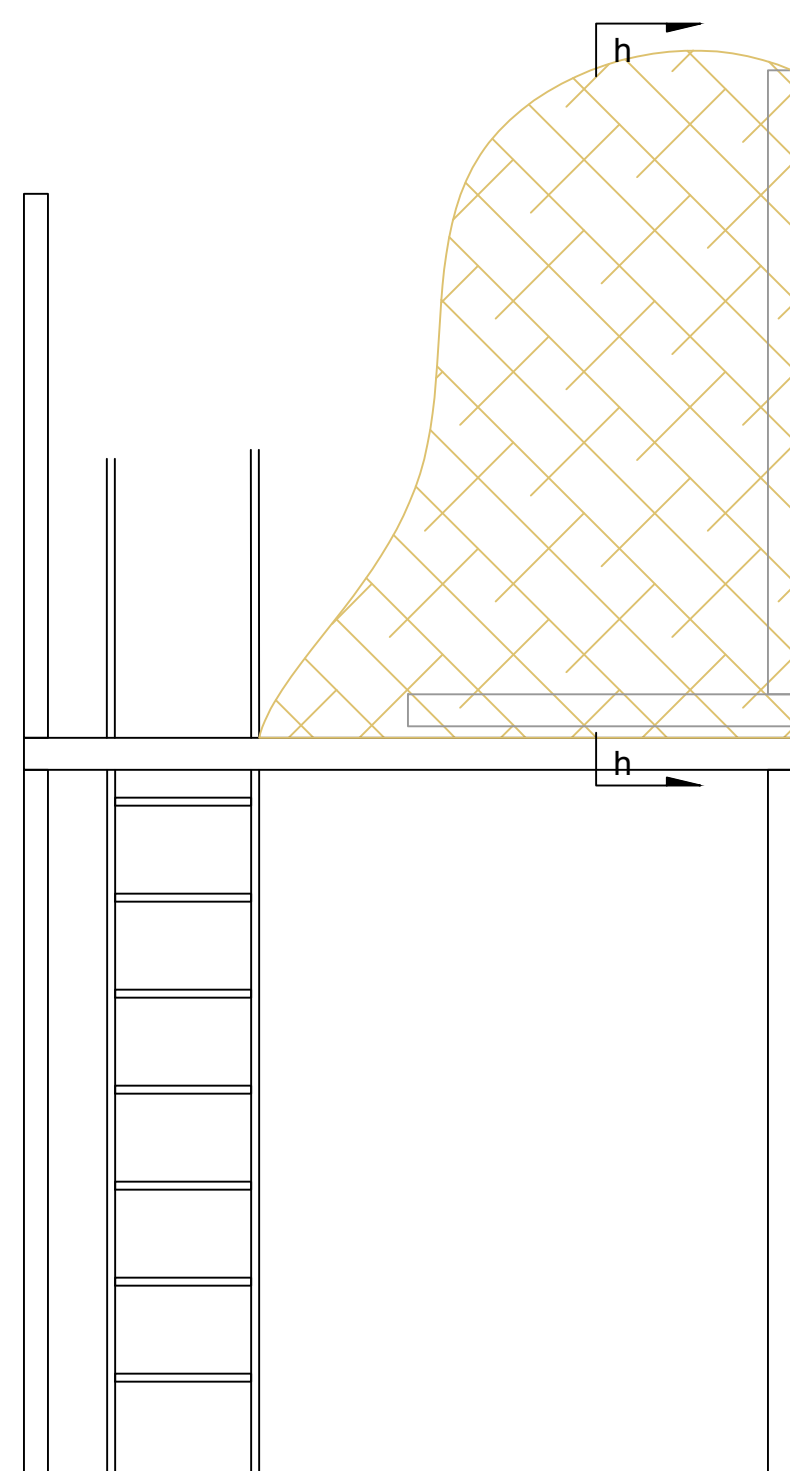

PLATFORM G  
UPPER LEVEL  
MOUNTAIN FABRIC

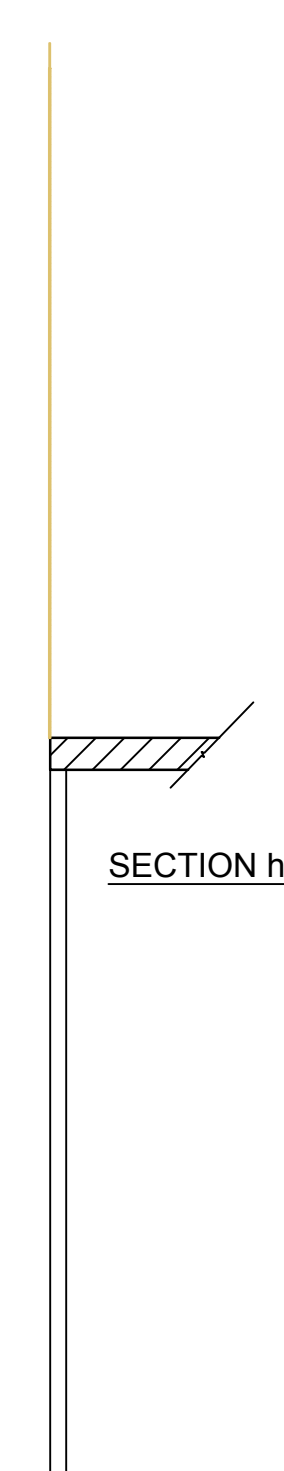

SECTION h

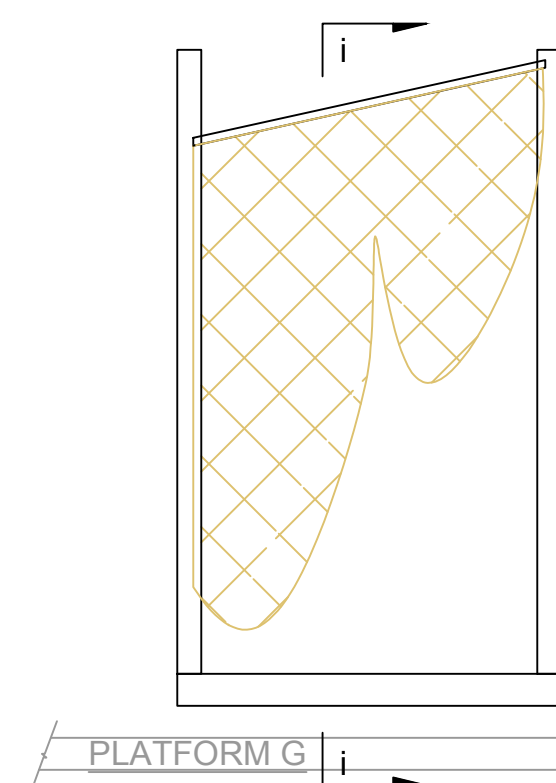

PLATFORM H  
UPPER LEVEL FABRIC

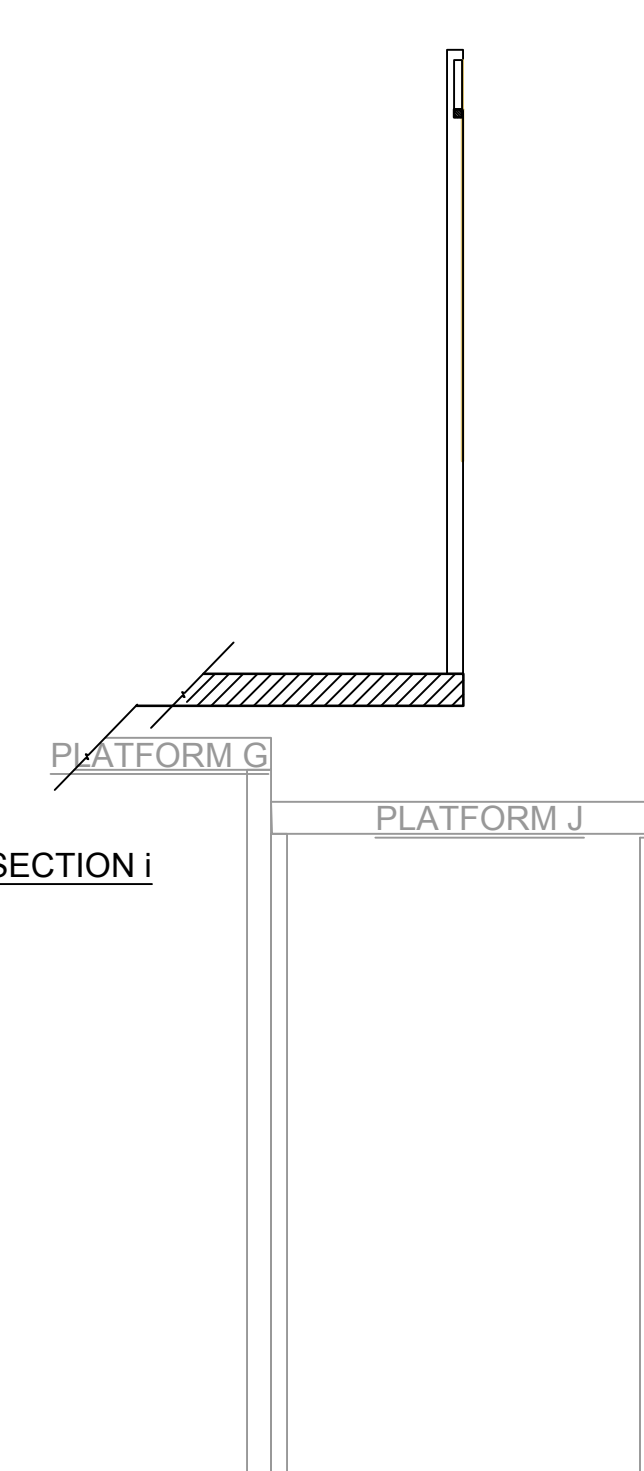

PLATFORM J  
LOWER LEVEL  
FABRIC

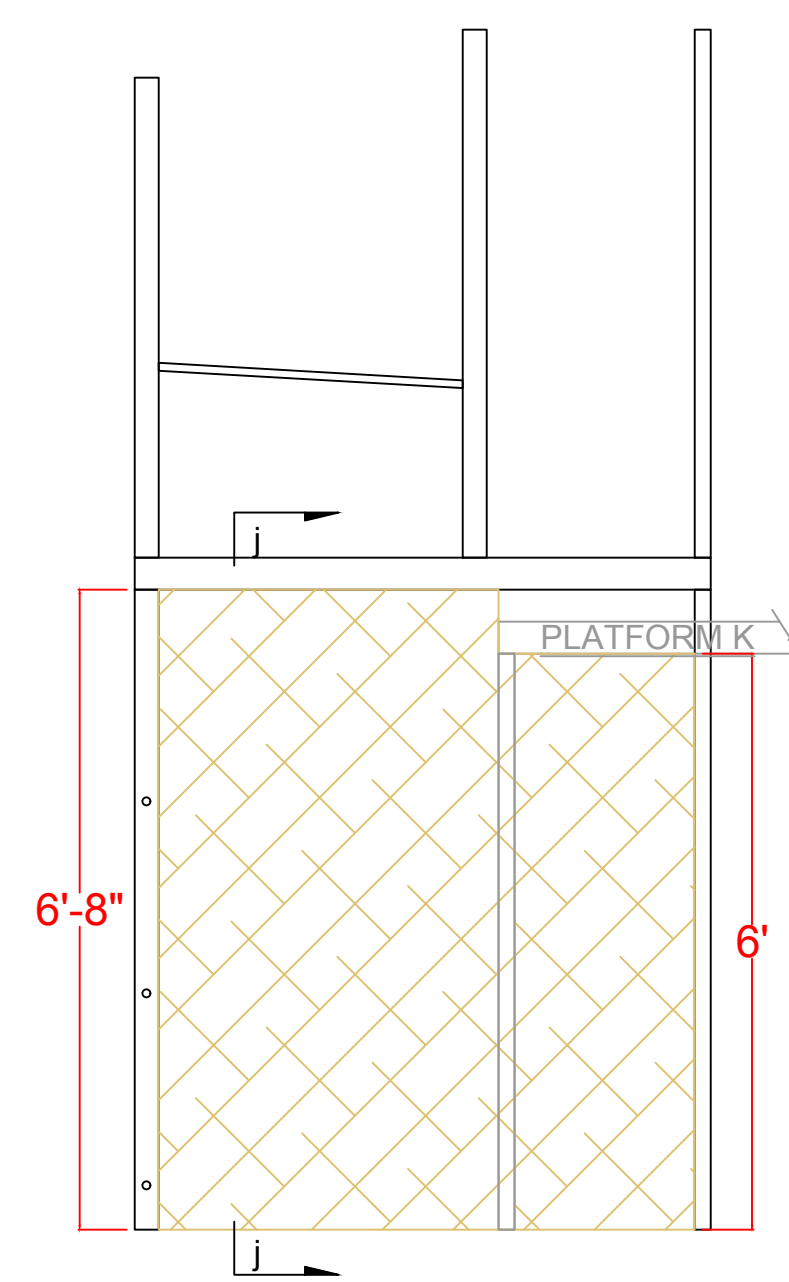

PLATFORM K  
LOWER LEVEL  
FABRIC

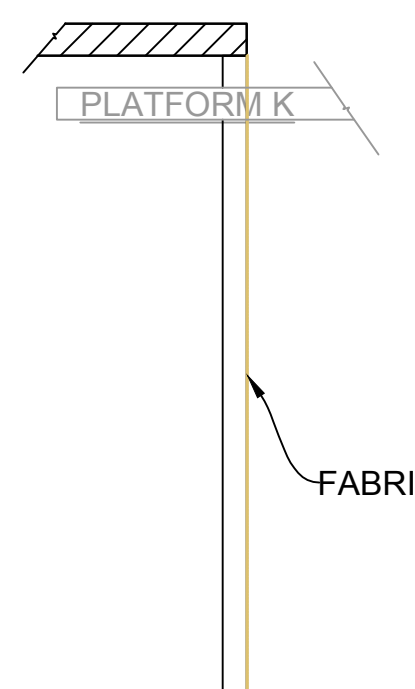

SECTION j

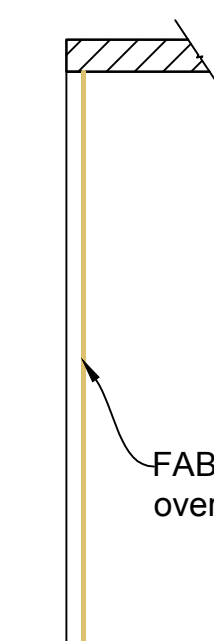
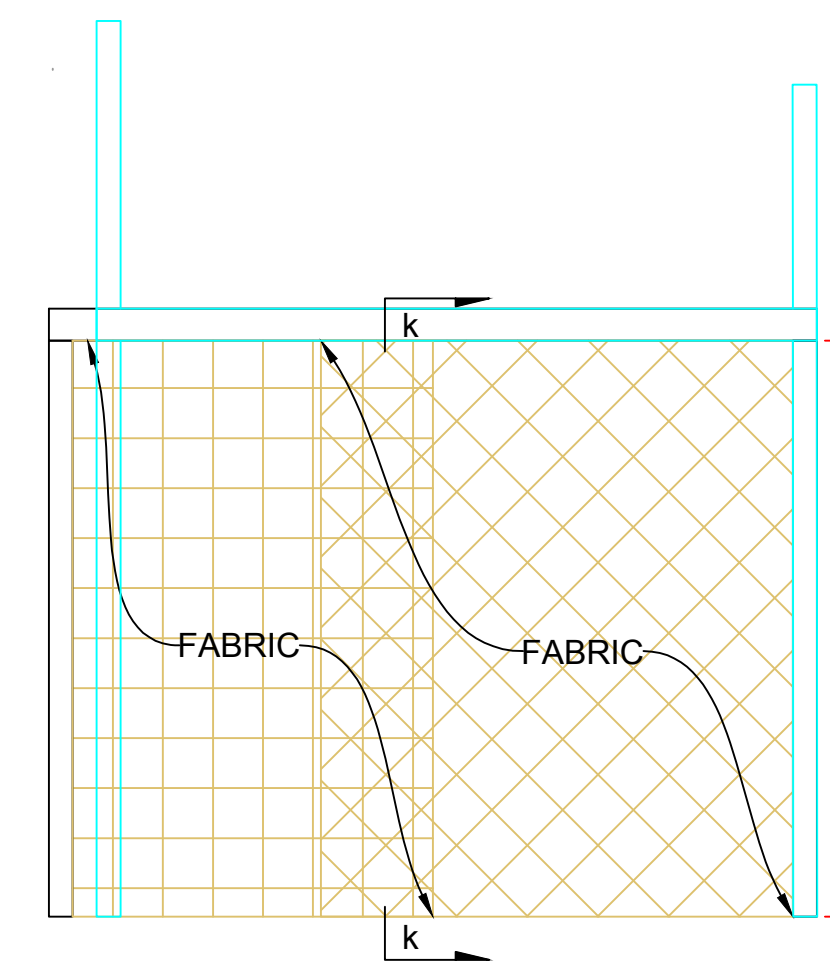

SECTION k

**NOTES:**

- Scrim is used in specific areas to support visual images (projection and lights) of layering (under the Platform D, E, and F). Other types of fabric can be used for the rest. See designer. All fabric should be treated similarly (aged).
- Scrim used in Platform D, E, and F are installed rolled up and will need to be pulled down/up as needed.

**LABEL CODING**

Date 5.15.2023

Drawn MK

Tech Director

File Name Luminary Arts Center

Scale 1/2"=1'-0"

Production:  
KFZ

Drawing Title  
FABRIC for Platforms

Revision #  
6.7.2023

Drawing #

5